

Precision Linear Transducers, Conductive Plastic, up to 450 mm

FEATURES

- Large measurement range
- High accuracy $\pm 1\%$ down to $\pm 0.05\%$
- Essentially infinite resolution
- Easy mounting

RoHS
COMPLIANT

The 110 L is a compact, robust, easily mounted precision industrial motion transducer.

ELECTRICAL SPECIFICATIONS	
Theoretical Electrical Travel (TET) = E	25 mm to 450 mm in increments of 25 mm
Independent Linearity (over TET) On Request	$\leq \pm 1\% \leq \pm 0.1\%$ $\leq \pm 0.05\%$ for $E \geq 100$ mm
Actual Electrical Travel (AET)	See Electrical Connections Table 1
Repeatability	$\leq 0.01\%$
Ohmic Values (R_T)	From 400 Ω /cm to 2 k Ω /cm
Resistance Tolerance at 20 °C	$\pm 20\%$
Maximum Power Rating	0.05 W/cm at 70 °C, 0 W at 125 °C
Wiper Current	Recommended: a few μ A - 1 mA max. (continuous)
Load Resistance	Minimum $10^3 \times R_T$
Insulation Resistance	≥ 1000 M Ω , 500 V _{DC}
Dielectric Strength	≥ 750 V _{RMS} , 50 Hz

MECHANICAL SPECIFICATIONS	
Mechanical Travel	TET + 6 mm min.
Housing	Anodized aluminum
Operating Force	5 N typical
Shaft (Free Rotation)	Stainless steel
Termination On Request	Connector: 723 series by cable
Wiper	Precious metal multifinger
Mounting	Movable brackets

PERFORMANCE	
Operating Life	40 million cycles typical/1 Hz/T° = 20 °C \pm 5 °C/80 % TET
Temperature Range	- 55 °C to + 125 °C
Mechanical Shocks on 3 Axes	50 g - 11 ms - half sine
Sine Vibration on 3 Axes	1.5 mm peak to peak or 15 g - 10 Hz - 2000 Hz
Speed (max.)	8 m/s for $f < 2$ Hz; 3 m/s for $f < 5$ Hz

Series REC 110 L

Vishay Sfernice

Precision Linear Transducers, Conductive Plastic,
up to 450 mm



DIMENSIONS in millimeters, general tolerance ± 1 mm

STANDARD MODEL

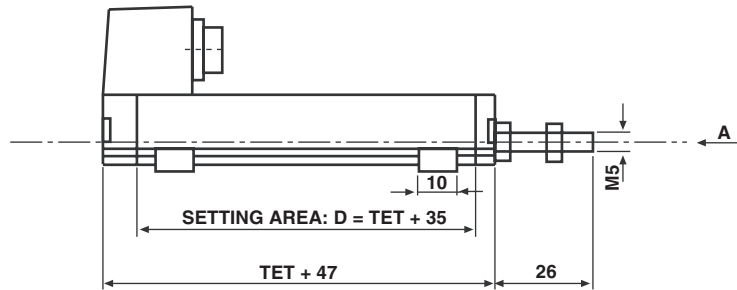
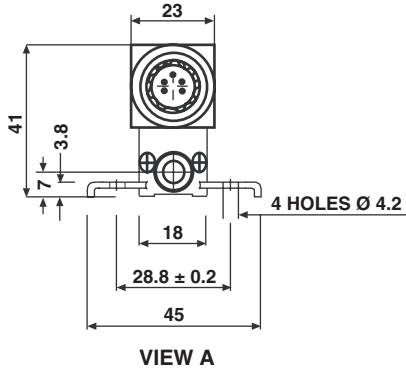

WITH CABLE OUTPUT: W04029

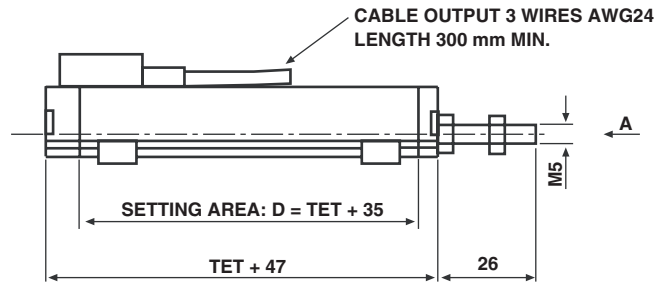
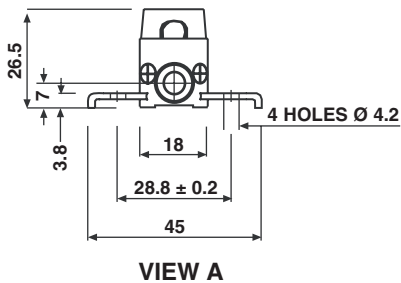

ELECTRICAL CONNECTIONS

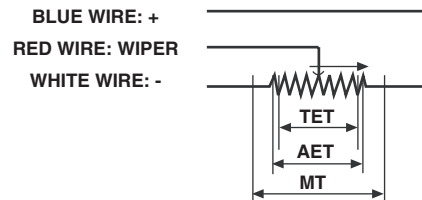
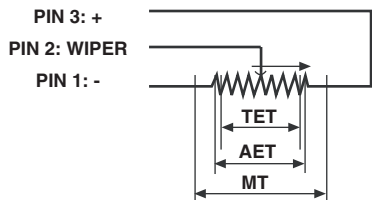

TET = THEORETICAL ELECTRICAL TRAVEL
AET = Actual ELECTRICAL TRAVEL
MT = MECHANICAL TRAVEL

Table 1

THEORETICAL ELECTRICAL TRAVEL TET	ACTUAL ELECTRICAL TRAVEL AET	TOLERANCE
From 25 mm to 275 mm	$TET + 1$ mm	± 0.5 mm
From 300 mm to 450 mm	$TET + 1$ mm	± 0.8 mm



OPTION: SPRING LOADED SHAFT DIMENSIONS in millimeters, general tolerance ± 1 mm

110L WITH SPRING LOADED SHAFT: W04030

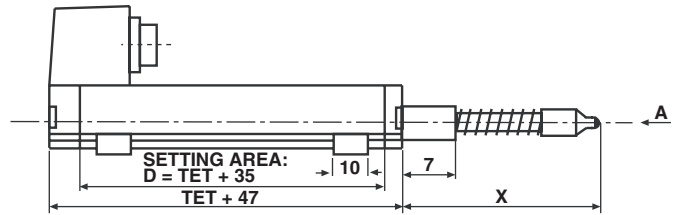
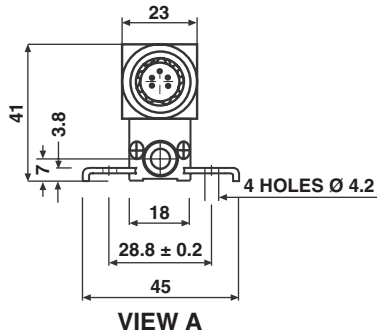
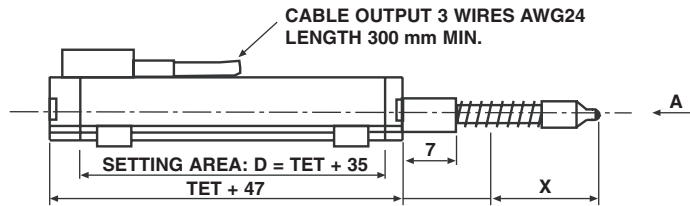
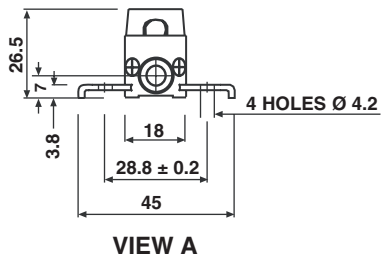

Table 2

MODEL	X
110 L1	75
110 L2	112
110 L3	150
110 L4	188

110L WITH CABLE OUTPUT AND SPRING LOADED SHAFT: W04031



Series REC 110 L

Vishay Sfernice

Precision Linear Transducers, Conductive Plastic,
up to 450 mm



ACCESSORIES ON REQUEST DIMENSIONS in millimeters, general tolerance ± 1 mm

- 1) FEMALE CONNECTOR
Vishay's Reference: 328870

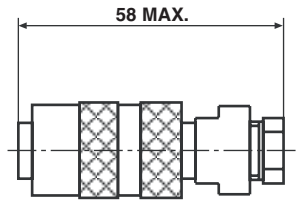

- 2) SPECIAL BALL JOINT
Vishay's reference: 323654

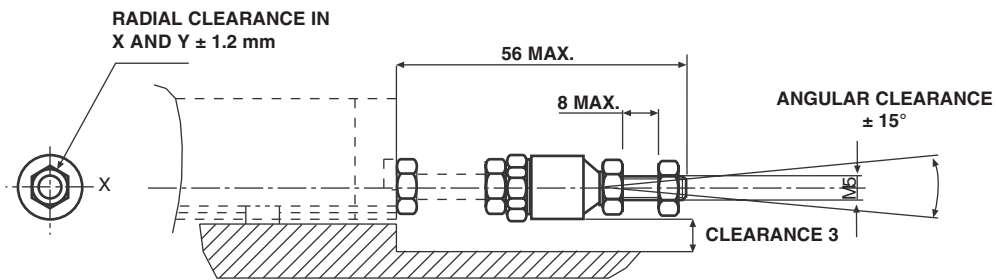

ORDERING INFORMATION/DESCRIPTION

REC	110	L	3	D	103	W...	e.
SERIES	MODEL	NUMBER OF TRACKS	THEORETICAL ELECTRICAL	LINEARITY	OHMIC VALUE	MODIFICATIONS	LEAD FINISH
		L = 1 track	Times 25 mm	A: $\pm 1\%$ D: $\pm 0.1\%$ E: $\pm 0.05\%$	First 2 digits are significant numbers 3rd digit indicates number of zeros	Special feature code number	

SAP PART NUMBERING GUIDELINES

RE	110 L	3	D	103	W....
SERIES	MODEL	TET	LINEARITY	OHMIC VALUE	SPECIAL FEATURES



Disclaimer

All product specifications and data are subject to change without notice.

Vishay Intertechnology, Inc., its affiliates, agents, and employees, and all persons acting on its or their behalf (collectively, "Vishay"), disclaim any and all liability for any errors, inaccuracies or incompleteness contained herein or in any other disclosure relating to any product.

Vishay disclaims any and all liability arising out of the use or application of any product described herein or of any information provided herein to the maximum extent permitted by law. The product specifications do not expand or otherwise modify Vishay's terms and conditions of purchase, including but not limited to the warranty expressed therein, which apply to these products.

No license, express or implied, by estoppel or otherwise, to any intellectual property rights is granted by this document or by any conduct of Vishay.

The products shown herein are not designed for use in medical, life-saving, or life-sustaining applications unless otherwise expressly indicated. Customers using or selling Vishay products not expressly indicated for use in such applications do so entirely at their own risk and agree to fully indemnify Vishay for any damages arising or resulting from such use or sale. Please contact authorized Vishay personnel to obtain written terms and conditions regarding products designed for such applications.

Product names and markings noted herein may be trademarks of their respective owners.

Precision Linear Transducers, Conductive Plastic, up to 1000 mm



FEATURES

- Measurement range 25 mm to 1000 mm
- High accuracy $\pm 1\%$ down to $\pm 0.025\%$
- Excellent repeatability
- Essentially infinite resolution
- Non sensitive to temperature variations

RoHS
COMPLIANT

The 115 L is a simply mounted, robust, high precision industrial linear motion transducer.

ELECTRICAL SPECIFICATIONS	
Theoretical Electrical Travel (TET) = E	From 25 mm to 1000 mm in increments of 25 mm
Independent Linearity (over TET) On Request	$\leq \pm 1\% \leq \pm 0.1\%$ $\leq \pm 0.05\%$ for $E \geq 100$ mm $\leq \pm 0.025\%$ for $E \geq 200$ mm
Actual Electrical Travel (AET)	AET = TET + 1.5 mm min.
Ohmic Values (R_T)	400 Ω /cm to 2 k Ω /cm
Resistance Tolerance at 20 °C	$\pm 20\%$
Repeatability	$\leq \pm 0.01\%$
Maximum Power Rating	0.05 W/cm at 70 °C, 0 W at 125 °C
Wiper Current	Recommended: a few μ A - 1 mA max. (continuous)
Load Resistance	minimum $10^3 \times R_T$
Insulation Resistance	≥ 1000 M Ω , 500 V _{DC}
Dielectric Strength	≥ 1000 V _{RMS} , 50 Hz
Protection Resistor	Integrated inside the transducer to protect against errors when setting up (short circuit)

MECHANICAL SPECIFICATIONS	
Mechanical Travel	$E + 8 \pm 2$ mm
Housing	Anodized aluminum
Operating Force	7.5 N typical
Shaft (Free Rotation)	Stainless steel
Termination	Hydraulic type connector DIN 43650
Wiper	Precious metal multifinger
Mounting	Movable brackets

PERFORMANCE	
Operating Life	40 million cycles typical/1 Hz/T° = 20 °C \pm 5 °C/80 % TET
Temperature Range	- 55 °C to + 125 °C
Sine Vibration on 3 Axes	1.5 mm peak to peak 0 - 10 Hz 15 g - 10 Hz - 2000 Hz
Mechanical Shocks on 3 Axes	50 g - 11 ms - half sine
Speed (max.)	8 m/s for $f < 2$ Hz; 3 m/s for $f < 5$ Hz

Series REC 115 L

Vishay Sfernice

Precision Linear Transducers, Conductive Plastic,
up to 1000 mm



DIMENSIONS in millimeters, general tolerance ± 1 mm

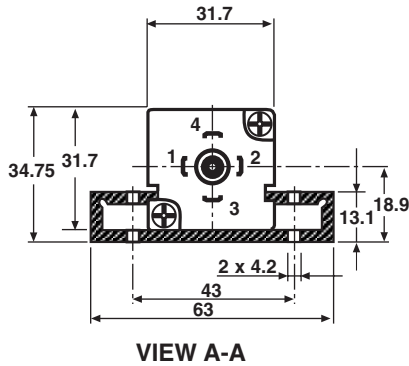

VIEW A-A

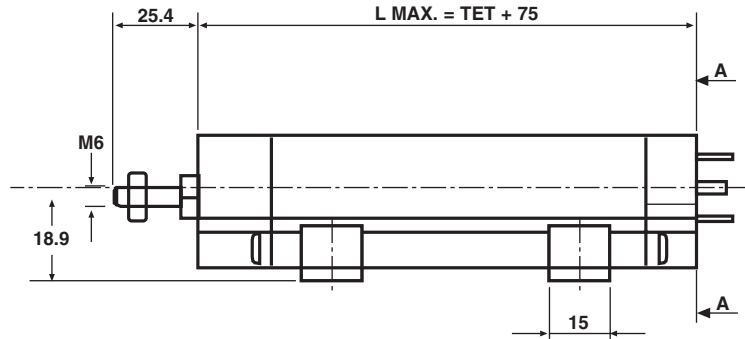

ELECTRICAL CONNECTIONS

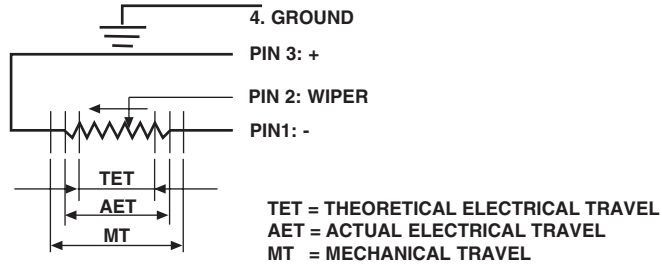

ACCESSORIES ON REQUEST DIMENSIONS in millimeters, general tolerance ± 1 mm

1) FEMALE CONNECTOR
Vishay's Reference: 3248610

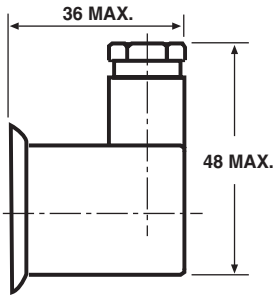

2) SPECIAL BALL JOINT ON SHAFT
Vishay's reference: 323655

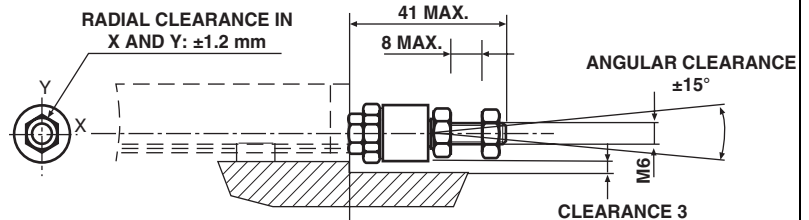

ORDERING INFORMATION/DESCRIPTION

REC SERIES	115 MODEL	L NUMBER OF TRACKS	23 THEORETICAL ELECTRICAL TRAVEL	D LINEARITY	103 OHMIC VALUE	W... MODIFICATIONS	e. LEAD FINISH
		L = 1	Times 25 mm	A: $\pm 1\%$ D: $\pm 0.1\%$ E: $\pm 0.05\%$ F: $\pm 0.025\%$	First 2 digits are significant numbers 3rd digit indicates number of zeros	Special feature code number	

SAP PART NUMBERING GUIDELINES

RE SERIES	115 L MODEL	23 TET	D LINEARITY	103 OHMIC VALUE	W... SPECIAL FEATURES
-----------	-------------	--------	-------------	-----------------	-----------------------



Disclaimer

All product specifications and data are subject to change without notice.

Vishay Intertechnology, Inc., its affiliates, agents, and employees, and all persons acting on its or their behalf (collectively, "Vishay"), disclaim any and all liability for any errors, inaccuracies or incompleteness contained herein or in any other disclosure relating to any product.

Vishay disclaims any and all liability arising out of the use or application of any product described herein or of any information provided herein to the maximum extent permitted by law. The product specifications do not expand or otherwise modify Vishay's terms and conditions of purchase, including but not limited to the warranty expressed therein, which apply to these products.

No license, express or implied, by estoppel or otherwise, to any intellectual property rights is granted by this document or by any conduct of Vishay.

The products shown herein are not designed for use in medical, life-saving, or life-sustaining applications unless otherwise expressly indicated. Customers using or selling Vishay products not expressly indicated for use in such applications do so entirely at their own risk and agree to fully indemnify Vishay for any damages arising or resulting from such use or sale. Please contact authorized Vishay personnel to obtain written terms and conditions regarding products designed for such applications.

Product names and markings noted herein may be trademarks of their respective owners.

Precision Linear Transducers, Conductive Plastic, up to 3000 mm



FEATURES

- Measurement range 25 mm to 3000 mm
- High accuracy $\pm 1\%$ down to $\pm 0.025\%$
- Excellent repeatability
- Essentially infinite resolution
- Simple mounting
- Actuation tolerant to some misalignment
- Reduced bulk



The 139 L is a robust industrial linear motion transducer with a side actuation, ideally suited for applications with very long travels.

ELECTRICAL SPECIFICATIONS	
Theoretical Electrical Travel (TET) = E	From 25 mm to 3000 mm in increments of 25 mm
Independent Linearity (over TET) On Request	$\leq \pm 1\%$; $\leq \pm 0.1\%$ $\leq \pm 0.05\%$ for $E \geq 100$ mm $\leq \pm 0.025\%$ for $E \geq 200$ mm
Actual Electrical Travel (AET)	AET = E + 1.5 mm min.
Ohmic Value (R_T)	400 Ω /cm to 2 k Ω /cm
Resistance Tolerance at 20 °C	$\pm 20\%$
Repeatability	$\leq 0.01\%$
Maximum Power Rating	0.05 W/cm at 70 °C, 0 W at 125 °C
Wiper Current	Recommended: a few μ A - 1 mA max. (continuous)
Load Resistance	Minimum $10^3 \times R_T$
Insulation Resistance	≥ 1000 M Ω , 500 V _{DC}
Dielectric Strength	≥ 1000 V _{RMS} , 50 Hz

MECHANICAL SPECIFICATIONS	
Mechanical Travel (MT)	See dimensions table 1
Housing	Anodized aluminum
Operating Force	2.5 N typical
Coupling	Self alignment
Termination	Hydraulic type connector DIN 43650
Wiper	Precious metal multifinger
Sealed to	IP53
Mounting	Movable brackets

PERFORMANCE	
Operating Life	40 million cycles typical/1 Hz/T° = 20 °C \pm 5 °C/80 % TET
Temperature Range	- 55 °C to + 125 °C
Sine Vibration on 3 Axes	1.5 mm peak to peak or 15 g - 10 Hz - 2000 Hz
Mechanical Shocks on 3 Axes	50 g - 11 ms - half sine
Speed (max.)	8 m/s for $f < 2$ Hz; 3 m/s for $f < 5$ Hz

Series REC 139 L

Vishay Sfernice

Precision Linear Transducers, Conductive Plastic,
up to 3000 mm



DIMENSIONS in millimeters, general tolerance ± 1 mm

STANDARD MODEL

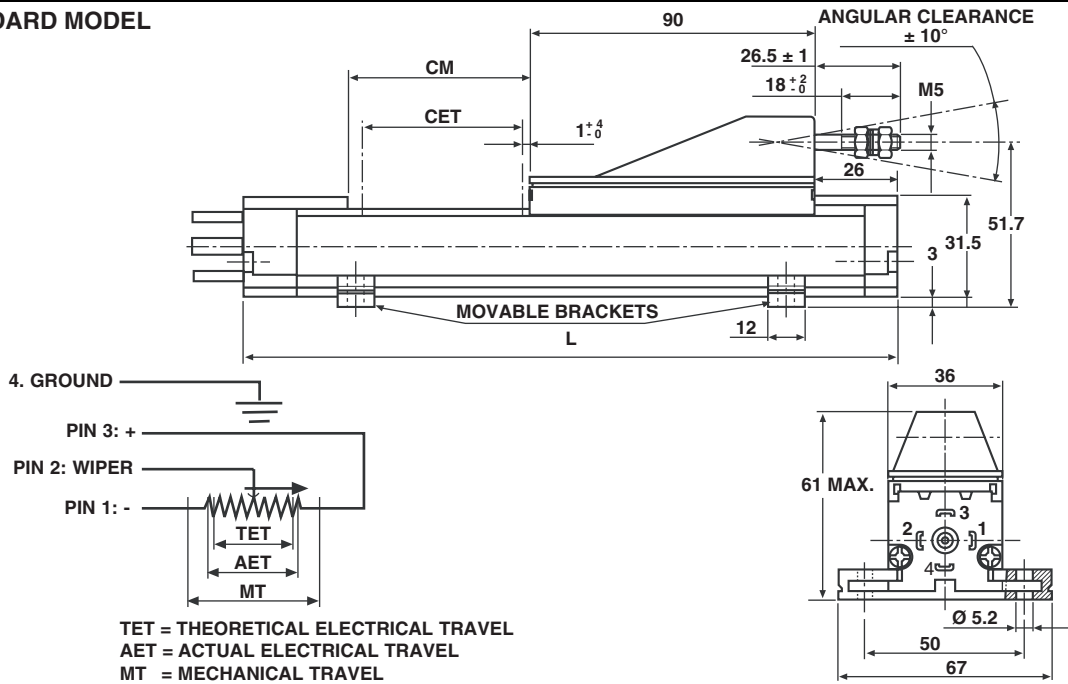

LENGTH	AET	MT	L
L1 to L20	TET + 1.5 min.	TET + 7 min.	TET + 158 max.
L21 to L40	TET + 1.5 min.	TET + 11 min.	TET + 163 max.
L41 to L120	TET + 1.5 min.	TET + 15 min.	TET + 169 max.

ELECTRICAL CONNECTIONS

FEMALE CONNECTOR
Vishay's Reference: 3248610

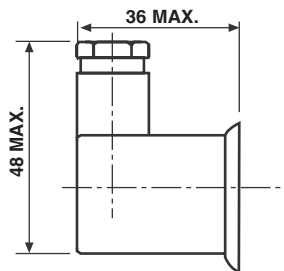

ORDERING INFORMATION/DESCRIPTION

REC	139	L	43	D	103	W...	e3
SERIES	MODEL	NUMBER OF TRACKS	THEORETICAL ELECTRICAL	LINEARITY	OHMIC VALUE	MODIFICATIONS	LEAD FINISH
		L = 1	Times 25 mm	A: $\pm 1\%$ D: $\pm 0.1\%$ E: $\pm 0.05\%$ F: $\pm 0.025\%$	First 2 digits are significant numbers 3rd digit indicates number of zeros	Special feature code number	Pure tin

SAP PART NUMBERING GUIDELINES

RE	139 L	43	D	103	W....
SERIES	MODEL	TET	LINEARITY	OHMIC VALUE	SPECIAL FEATURES



Disclaimer

All product specifications and data are subject to change without notice.

Vishay Intertechnology, Inc., its affiliates, agents, and employees, and all persons acting on its or their behalf (collectively, "Vishay"), disclaim any and all liability for any errors, inaccuracies or incompleteness contained herein or in any other disclosure relating to any product.

Vishay disclaims any and all liability arising out of the use or application of any product described herein or of any information provided herein to the maximum extent permitted by law. The product specifications do not expand or otherwise modify Vishay's terms and conditions of purchase, including but not limited to the warranty expressed therein, which apply to these products.

No license, express or implied, by estoppel or otherwise, to any intellectual property rights is granted by this document or by any conduct of Vishay.

The products shown herein are not designed for use in medical, life-saving, or life-sustaining applications unless otherwise expressly indicated. Customers using or selling Vishay products not expressly indicated for use in such applications do so entirely at their own risk and agree to fully indemnify Vishay for any damages arising or resulting from such use or sale. Please contact authorized Vishay personnel to obtain written terms and conditions regarding products designed for such applications.

Product names and markings noted herein may be trademarks of their respective owners.